

635nm~638nm 100mW~120mW MM Fiber Coupled Laser Diodes | Red Laser Diode
635nm Multi-mode Coaxial Pigtailed LD Module| 105um Fiber Core
WSLP-635-100m-M
Wavespectrum Laser Group
www.wavespectrum-laser.com

635nm Pigtailed Diode Laser		Wavespectrum Laser Group	
PARAMETER	SYMBOL	VALUE	UNIT
Reverse Voltage	V_r	2.0	V
Operating Temperature	T_{op}	-5 ~ +50	°C
Storage Temperature	T_{stg}	-40 ~ +100	°C
Lead soldering temperature (10 sec.)	T_{is}	260	°C
Features: <ul style="list-style-type: none"> ● 635nm ● MM Fiber ● Coaxial Package 			
Applications: <ul style="list-style-type: none"> ● Medical Laser Treatment ● Others 			
Specifications	WSLP-635-100m-M		
	Min	Type	Max
Center Wavelength@25°C	630nm	638nm	645nm
Spectral Width (FWHM)	----	2.0nm	----
Output Power	----	100mW	----
Fiber Core	105um		
Recommended Operating Temperature	25°C		
Fiber Connector	FC/SC/SMA905		
Fiber Length	----	80cm	100cm
Threshold Current (Typ.)	----	135mA	180mA
Operating Current (Typ.)	----	400mA	440mA
Operating Voltage	----	2.2V	2.5V
Package Style	Coaxial		

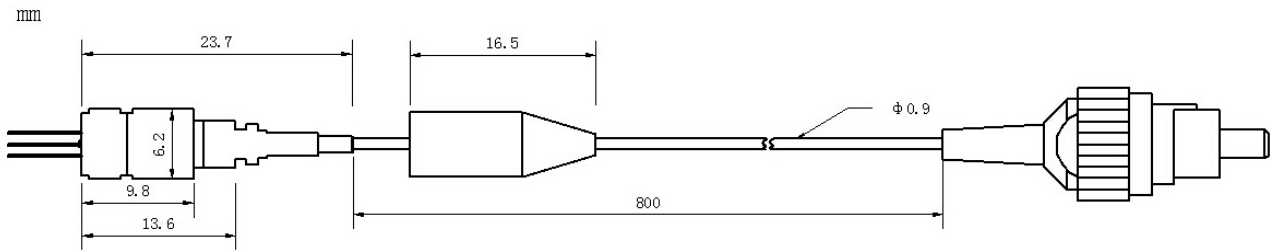

Coaxial Package View



PIN Bottom View:

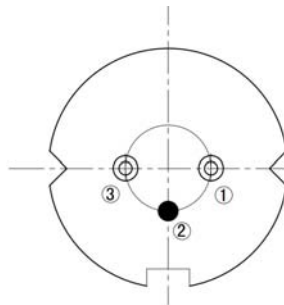

1	LD(+)
2	GND
3	LD(-)

Electrically shorten LD module and store in non-extreme conditions.

Suggest using the constant current power supply.

